

WSM20-DC

Smart WiFi6 Switch Module-DC

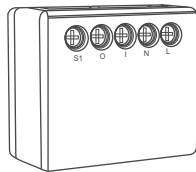

WiFi6

RoHS



TECHNICAL SPECIFICATIONS

Product type	Smart WiFi6 Switch Module-DC
Input	AC 110-240V 50/60Hz
Output	Max 8A/2000W @240V AC Max 5A/150W @30V DC
WiFi Signal replication	Support
WiFi Protocol	WiFi 6
Operation range	< 100m
Dims (W*D*H)	34*29*17 mm
IP rating	IP20
Certificates	CE RoHS

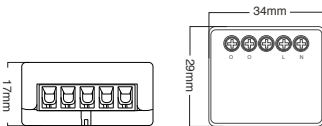

Global international operation Whenever & Wherever
You are, All-in-one Mobile App

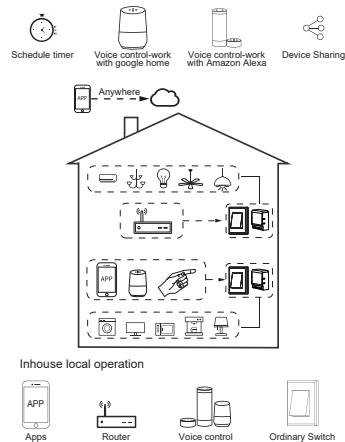

INSTALLATION

▲ Warnings:

1. Installation must be carried out by a qualified electrician in accordance with local regulations.
2. Keep the device out of reach of children.
3. Keep the device away from water, damp or hot environment.
4. Install the device away from strong signal sources such as microwave oven that may cause signal interruption resulted to abnormal operation of the device.
5. Obstruction by concrete wall or metallic materials may reduce the effective operation range of the device and should be avoided.
6. Do NOT attempt to disassemble, repair or modify the device.

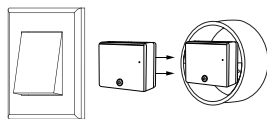

MANUAL OVERRIDE

The switch module terminal reserves the access of manual override function for the end-user to switch on/off.

- Switch on/off for permanent on/off function.

Notes:

- 1) Both the adjustment on App and switch can overwrite each other, the last adjustment remains in memory.
- 2) The App control is synchronized with the manual switch.

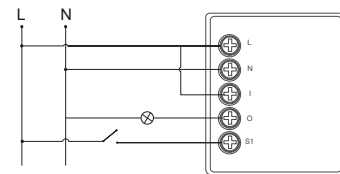

Double Switch

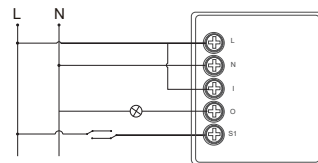

Wiring Instructions and Diagrams

1. Turn off the power supply before carrying out any electrical installation work.
2. Connect wires according to the wiring diagram.
3. Insert the module into the junction box.
4. Turn on the power supply and follow switch module configuration instructions.

FAQ

- Q1: What should I do if I can't configure the switch module?
- a. Please check whether device is powered on.
 - b. Make sure your mobile and dimmer module are the same 2.4 Ghz WiFi network.
 - c. Whether it's in good internet conditions.
 - d. Make sure the password entered in App is correct.
 - e. Make sure the wiring is correct.

Q2: What device can be connected to this Wi-Fi switch module?

Most of your household electrical appliances, such as lamps, laundry machine, coffee maker, etc.

Q3: What happens if the WiFi goes off?

You can still control the device connected the switch module with your traditional switch and once WiFi is active again the device connected to module will connect automatically to your WiFi network.

Q4: What should I do if I change the WiFi network or change the password?

You have to re-connect our Wi-Fi switch module to the new Wi-Fi network accordingly as per the App User Manual.

Q5: How do I reset the device?

1. Power on/off device for 5 times until the indicator light flash.
2. Switch on/off the traditional switch for 5 times until the indicator light flash.
3. Press the reset key for about 10 seconds until the indicator light flash.

PREPARATION FOR USE

Step 1.

Search for "Smart Life" in the App store or scan the QR code in the manual to download and install the App. Press the "Register" button register an account if this is your first time use; if you already have an account, press the "Login" button.



IOS APP / Android APP

Step 2.

Press and hold the device's network pairing button for 10 seconds, make the backlight flashing.

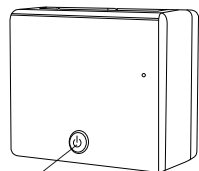

Reset key

Step 3.

Make your phone connect to wifi (must be 2.4G). Then open bluetooth.

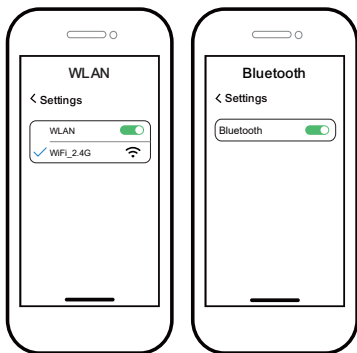

Step 4.

Add device as shown in the figure.

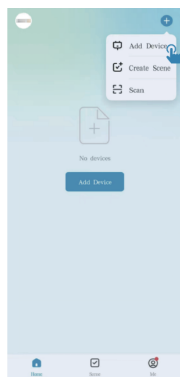

1

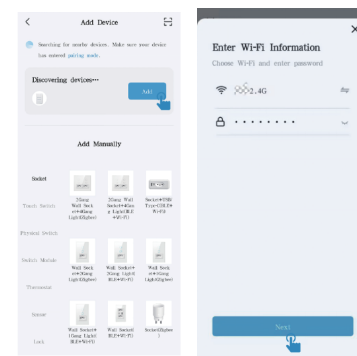

2

3

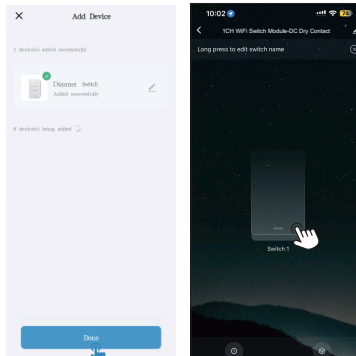

4

5



6

Note: If the network configuration fails, do the steps 2 and connect again.