

# INSTRUCTION MANUAL Zigbee Curtain Module

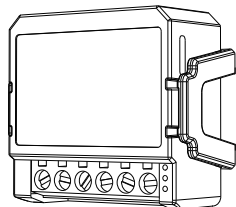

RoHS



## TECHNICAL SPECIFICATIONS

Product type	Zigbee Curtain Module
Voltage	AC100-240V 50/60Hz
Max. load	3A
Operation frequency	2.412GHz-2.484GHz
Operation temp	-10℃ + 40℃
Protocol	Zigbee
Dims (WxDxH)	39x39x19.4 mm
IP rating	IP20
Warranty	2years
Certificates	CE ROHS

with mounting clip

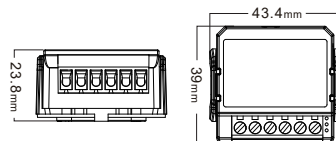

Global international operation Whenever & Wherever  
You are, All-in-one Mobile App

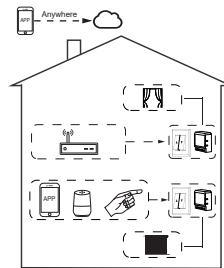

Inhouse local operation

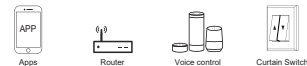

## INSTALLATION

### ▲Warnings:

1. Installation must be carried out by a qualified electrician in accordance with local regulations.
2. Keep the device out of reach of children.
3. Keep the device away from water, damp or hot environment.
4. Install the device away from strong signal sources such as microwave oven that may cause signal interruption resulted to abnormal operation of the device.
5. Obstruction by concrete wall or metallic materials may reduce the effective operation range of the device and should be avoided.
6. Do NOT attempt to disassemble, repair or modify the device.

## MANUAL OVERRIDE

The Curtain module terminal reserves the access of manual override function for the end-user to switch on/off.

- If you have connected the wall push-button, check its work.  
Single pressing of the "down" button / "up" button, will cause that the roller shutters moves in the desired direction to the end position. If the electric shutter goes in the opposite direction to the expected, select "motor reversal" in the "More" option. When the electric shutter is moving up, press-ing "up" button switches causes that the shutter will stop immediately; when the electric shutter is moving down, pressing "down" button switches causes that the shutter will stop immediately.

Notes:

- 1) Both the adjustment on App and Curtani can overwrite each other, the last adjustment remains in memory.
- 2) The App control is synchronized with the manual switch.
- 3) Traditional switch selection button type.

## Wiring Instructions and Diagrams

1. Turn off the power supply before carrying out any electrical installation work.
2. Connect wires according to the wiring diagram.
3. Insert the module into the junction box.
4. Turn on the power supply and follow switch module configuration instructions.

Notes: Before pairing the device, please confirm that the Zigbee gateway is connected to the network and use the gateway to pair the device.

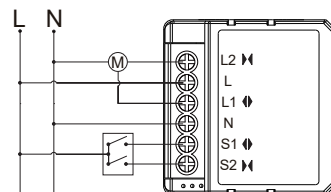
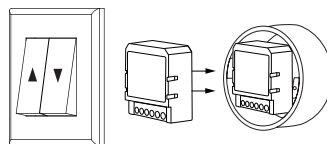

## FAQ

Q1: What should I do if I can't configure the switch module?

- a. Please check whether device is powered on.
- b. Ensure that your Zigbee gateway is connected to the network, and that the Wi-Fi and Bluetooth on your mobile phone are turned on.
- c. Whether it's in good internet conditions.
- d. Make sure the password entered in App is correct.
- e. Make sure the wiring is correct.

Q2: What happens if the Zigbee gateway goes off?

You can still control the light connected the dimmer module with your traditional switch and once gateway is active again the device connected to module will connect automatically to your Zigbee gateway.

Q3: What should I do if I change the WiFi network or change the password?

You only need to connect the gateway, which has already been paired with the device, to a new network, and then the device can continue to be used.

Q4: How do I reset the device?

- a. Power on/off device for 5 times until the indicator light flash.
- b. Press the reset key for about 10 seconds or turn on/off the traditional switch for 5 times until the indicator light inside the module is flashing quickly for pairing.

## APP USER MANUAL



### IOS APP / Android APP

1

Scan the QR code to download "Tuya Smart" App, or you can also search keyword "Tuya Smart" or "Smart Life" at App Store or Googleplay to download App.

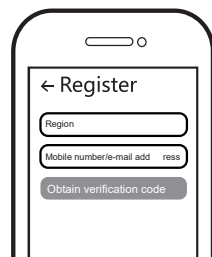

2

Log in or register your account with your mobile number or e-mail address. Type in the verification code sent to your mobile or mail box, then set your login password. Click "Create Family" to enter into the APP.

Reset key

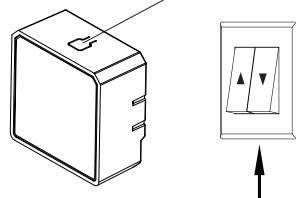

3

After the wiring of switch module is done, press the reset key for about 10 seconds or turn on/off the traditional switch for 5 times until the indicator light inside the module is flashing quickly for pairing.

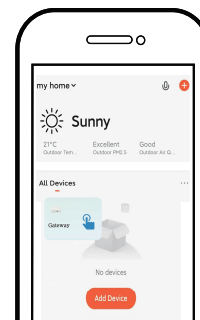

4

1. Confirm that you have connected to the Zigbee gateway.
2. Turn on Bluetooth, Click Gateway, Select "Add Device" according to the options in the gateway.

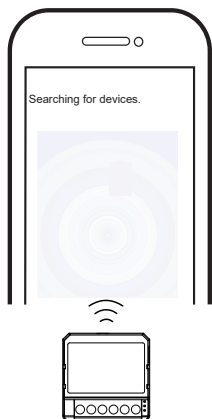

5

The connecting will take about 10-120 seconds to complete depending on your network condition.

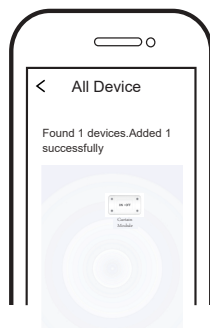

6

Finally, you can control the device via your mobile phone.

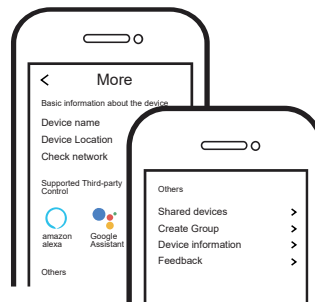

7

Connect to amazon alexa or Google Assistant for voice control, or share the devices with your families or friends.

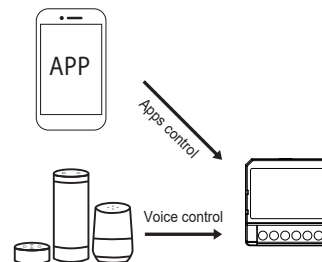

8

Enjoy your smart life of home automation for lighting control by using our All-in-one mobile app wherever you are in the world or simply by voice control when you are sitting at home comfortably.