

Series Thermostat User Guide

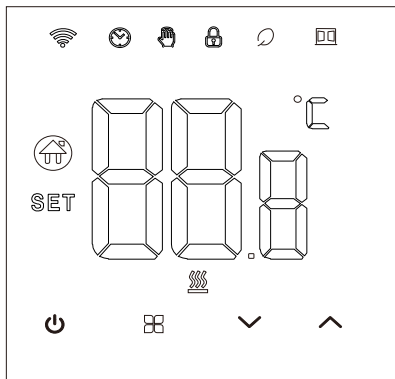

This thermostat is used for water heating, electric heating, or gas boiler.

Thermostat User Guide

Welcome

Thank you for your trust and support!

We have adopted advanced technology and perfect craftsmanship so that your new thermostat will provide you with a suitable temperature environment every day in the future. It makes your life more pleasant and artistic and making your living environment more fashionable aesthetic.

For detailed instructions on installing and using this thermostat, please read this manual carefully.

Please get in touch with a professional to install the thermostat for you. Besides, please install and use this product within the scope of the law.

Application

The intelligent digital humidity controller is a floor heating system suitable for room temperature control and household temperature control. It controls the operating status of the floor heating equipment by sensing the comparison between the ambient temperature and the set temperature. While improving comfort, it achieves the purpose of energy saving.

The digital thermostat adopts microcomputer control technology and has an elegant design, and is easy to use. Moreover, it has manual and automatic functions, programmable functions, and state memory functions.

Thermostat User Guide

Product packaging

Thermostat host 1 PCS Guide/manual 1PCS

Certificate of conformity 2PCS screw 1PC

Sensing line (optional) 1PCS

1.: Backlight (You can adjust the brightness through the mobile phone APP or turn on the backlight)

R2: Internal sensor and external sensor on the ground

GA : Water heating 3A;

GB : Electric heating 16A

GC : Linkage; M: Gas boiler 3A

GE : for water heating+for gas boiler

Electrical Specifications

1.Temperature Sensor :NTC

2.Temperature accuracy : $\pm 1^{\circ}\text{C}$

3. Display screen: LCD

4. Working environment: $-5\sim 50^{\circ}\text{C}$

5. Self-consumption power: $<1\text{W}$

6. Temperature setting: $5\sim 60^{\circ}\text{C}$

7. Display range: $0\sim 51^{\circ}\text{C}$

8. Load current: water heater 3A

(resistive) electric heater 16A

9. Voltage : AC100-240V, 50/60Hz

(resistive) 02

Thermostat User Guide

About WIFI connection

Before using the WIFI temperature controller for the first time, you must set the WIFI value number and configuration via your smartphone or tablet, which will allow communication between your connected devices.

WIFI connection: When the thermostat is turned on, press and hold the up button for 5 seconds, the WIFI icon flashes on the thermostat display, and the thermostat enters the code matching state.

WIFI connection: Bluetooth thermostat, please turn on the phone's Bluetooth

1. APP download

Search for "Tuya Smart" in each APP market or scan the following QR code to download this software:



Thermostat User Guide

Mounting steps

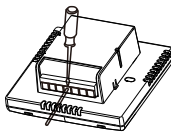

1. Connect the power box according to the wiring diagram

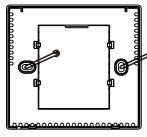

3. Screw the power supply into the box of 86

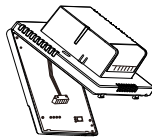

2. Separate the power supply from the control board cable

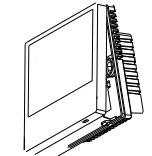

4. Connect the power board to the control board line, and align the buckle at 30 degrees to complete the installation.

Thermostat User Guide

Icon description

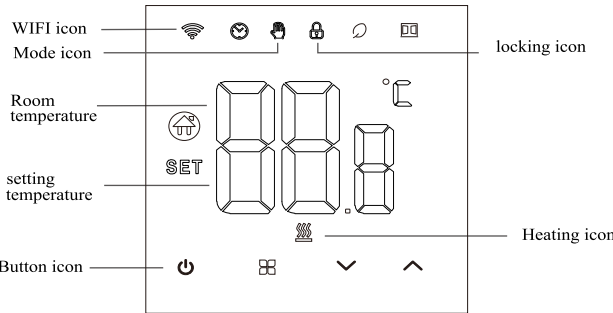

Thermostat User Guide

3. Add device

1: (Bluetooth connection) Turn on the mobile phone's Bluetooth, turn the device on, and enter the Tuya APP. Click "Add Device" or "+" on the top right of the APP homepage, and enter the "Add Device" interface. It will prompt: find the device to be added (Figure 2) and follow the prompts.

2: "Automatic discovery": Search for devices (Figure 3), and add widgets as prompted on the phone page

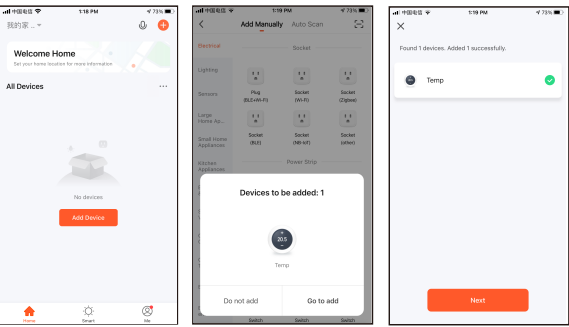

Thermostat User Guide

If the network configuration fails, the APP will display the page as shown in the figure below, and you can choose to add it again or view the help.

Note: Please confirm whether the thermostat enters the code matching state if the connection fails.

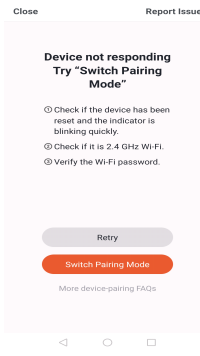

Thermostat User Guide

2. Register an account

If you do not have an APP account, you can choose to register or log in via SMS verification code. Click "Create New Account" to enter the privacy policy page of Tuya Smart Platform. After clicking Agree, you will formally join the registration page of your mobile phone number.

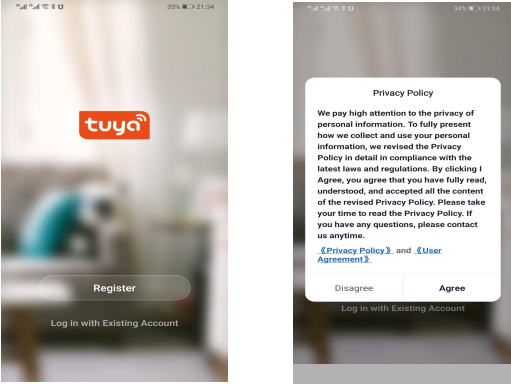

Thermostat User Guide

The system automatically determines the current country/region, or you can manually select the country/region, enter your phone number or email address, and click "Get the Verification Code."

Enter the received verification code. Then enter the password. Click "Finish" to register successfully.

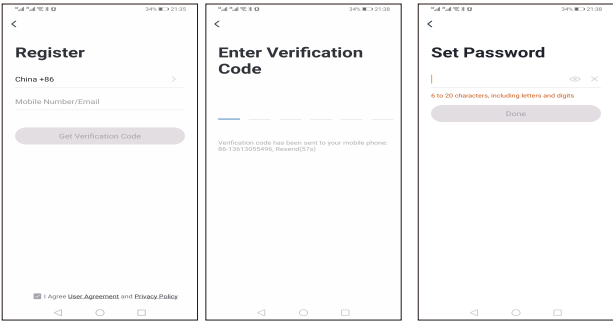

Thermostat User Guide

User Instructions

1. Read this manual carefully. A general operation may damage the product or cause a dangerous situation.

2. The installation personnel must be well-trained and experienced service technicians.

3. After the installation is complete, please close this manual carefully and operate this product following the user guide. Note: There is a risk of electric shock or equipment damage.

Wiring Diagram

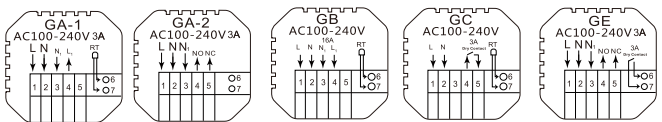

GA : Water heating

GB : Electric heating

GC : Gas boiler heating

GE : for water heating+for gas boiler

Thermostat User Guide

Time programming instructions

Options	Icon	Time	Time Adjustment	Defaults	Temperature adjustment
Working days	1	06:00	^	20°C	^
	2	08:00		16°C	
	3	11:30		16°C	
	4	12:30	v	22°C	v
	5	17:00		16°C	
	6	22:00		16°C	
Holidays	1	08:00	v	22°C	v
	2	23:00		16°C	

Thermostat User Guide

Advanced Option Setting

In the shutdown state, press the key and key. Press for 5 seconds to enter the advanced option setting

Press the key to enter the next option; then press the up/down key to adjust options, and press the key to exit the advanced option setting mode.

01	Temperature compensation	Press the up or down key to adjust the range from 0.0°C to -9.9°C.
02	Sensor selection	The temperature sensor selection defaults to IN. Press the up key or the down key to adjust it respectively to Pt external sensor selection. ALL means all internal sensors are selected. OUT means external sensors are set.
03	Limit temperature value modification	The limit temperature value is 60°C by default. Press the up or down key to adjust the range from 5°C to 65°C.
04	Temperature difference setting	The default setting temperature difference start is 1°C; press the up or down key to adjust the range from 0.5°C to 10°C.
05	Auxiliary function	Set the auxiliary function on/off by default; press the up key to turn on the auxiliary function.
06	Stop the selection (optional) and closing work programming	1: 7-day weekend 2: Single day-off 3: No rest 4: Single day-off 5: Turn off programming
07	Main and aux reverse selection (optional)	Set the main and auxiliary reverse to 00 by default. Press the up or down key to adjust 00 main reverse, and 01 to indicate the auxiliary reverse.
08	Backlight brightness	01: Micro-light 02: Medium brightness 03: Backlight highlight
09	Set temperature upper limit	Set the upper limit of the temperature to 65°C; press the up or down key to adjust the range from 5°C to 65°C.
10	Sound	ON: Turn on the sound OFF: Turn off the sound
11	Window opening detection	Start: The room temperature drops by 6 degrees within 4 minutes and stop heating. Close: The room temperature rises by 3 degrees. Close after 40 minutes. (Other methods) After the window opening mode is enabled, any one of these three conditions can trigger the exit of the window opening mode.
12	Power outage memory function	0: memory function 1: Turn on after turning on the power 2: Turn off after turning on the power
13	Reset	Set to restore factory settings. The default display is "V" press the up key to display "V" and then press the enter key to restore the factory settings.
14	Night mode	Night mode refers to turning off the backlight source. The default night mode is OFF. You can adjust the opening or closing time on APP

Thermostat User Guide

Operation Guide

- Power on/off: press the key to turn on/off the thermostat.
- Press the key to switch between manual and Away modes.
- Simultaneously press and hold the up and down keys for 5 seconds to add or cancel the child lock.
- WiFi link: When the thermostat is turned on, press and hold the up button for five seconds, the WIFI icon flashes on the thermostat display, and the thermostat enters the code matching state.

Thermostat User Guide

4. Thermostat APP interface display

