

WT200D THERMOSTAT USER GUIDE



THIS THERMOSTAT IS SUITABLE FOR WATER HEATING,
ELECTRIC HEATING AND GAS BOILER

THERMOSTAT USER GUIDE

Welcome

Thank you for your trust and support. By adopting high-end technology and more perfect technology, your new thermostat will provide you with the right temperature environment every day in the future, making your life more comfortable and your living environment more dignified and beautiful. For detailed instructions on the installation and use of this thermostat, please read this manual carefully. Please contact a professional to install the thermostat for you and install and use the product to the extent permitted by law.

Application

Intelligent digital temperature controller is a floor heating system suitable for room temperature control and household temperature control. It controls the operating state of the floor heating equipment by comparing the ambient temperature with the set temperature, which improves comfort and achieves energy saving. This digital temperature controller adopts microcomputer control technology and is equipped with LED screen display touch buttons, which is elegant in design and easy to use. The thermostat has manual automatic, programmable and data memory functions.

①

THERMOSTAT USER GUIDE

Product packaging

Thermostat tool: 1 PC Manual: 1 PC
Qualification certificate: 1 PC Screw: 2PCS
Setting key: optional: 1 PC

Product Model

WT1 Pumping 3A
Electric heating 16A
BH Infrared gas boiler 3A

Description of display & icon

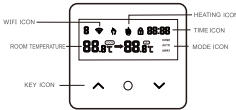

②

THERMOSTAT USER GUIDE

About WIFI connection

Before using the WIFI thermostat for the first time, you should set the WIFI signal and configuration through your smart phone or tablet to allow communication between your connected devices.

WIFI link: For Bluetooth thermostat, please turn on Mobile phone Bluetooth

1. Download the APP
Search for "Tuya" in App market or scan below QR Code to download



③

THERMOSTAT USER GUIDE

5. Add device: Click "Add device" or "+" on the top right of the APP homepage to enter the "Add device" page. Currently, there are two ways to manually add device and search device.

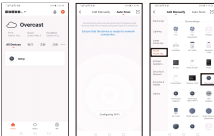

④

THERMOSTAT USER GUIDE

2. Register Account: If you don't have an APP account yet, you can choose to register or log in via third verification code. Click "Create a new account" you will enter the Tuya Smart Platform Privacy Policy page. After you click Agree, you will officially enter the mobile phone registration page.

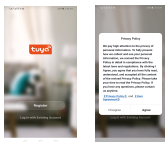

⑤

THERMOSTAT USER GUIDE

The system automatically determines the current country/region. You can also select the country/region manually. After entering your mobile phone number or email address, click "Get verification code". Enter the received verification code, then enter the password and click "Start" to register successfully.

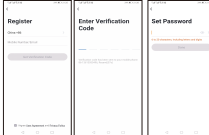

⑥

User Notes

1. Please read this manual carefully. Improper operation may damage the product or cause dangerous conditions.
2. The installation personnel must be well-trained and experienced service technicians.
3. After installation, please read this manual carefully and operate the product according to the instructions.
- Caution: Risk of electric shock or equipment damage.

Wiring Diagram

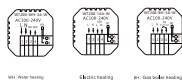

⑦

THERMOSTAT USER GUIDE

Installation procedure

This product is installed with a standard 60 control switch (in compliance with European regulations)

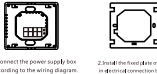

1. Connect the power supply box according to the wiring diagram.

2. Install the thermostat of thermostat to electrical connection box with screws.

⑧

THERMOSTAT USER GUIDE

Technical data

1. Temperature sensor: NTC
2. Temperature accuracy: $\pm 1^{\circ}\text{C}$
3. Power consumption: $< 1\text{W}$
4. Voltage: AC100-240V 50Hz
5. Load current: 3A/16A
6. Temperature setting: -5°C ~ 60°C

⑨

THERMOSTAT USER GUIDE

If the distribution network fails, the APP will display the page shown in the figure below. You can choose to add or view the help again. Note: If the connection fails, please confirm whether the temperature control device has entered the code matching state, refer to item 6 of the operation manual.



⑩

THERMOSTAT USER GUIDE

4. Display of temperature controller APP interface

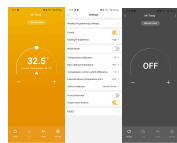

⑪

THERMOSTAT USER GUIDE

Operating Instruction

1. Power on/off: Long press **ON** for 5 seconds to turn off the thermostat.
2. Press the **Q** key to switch between manual and automatic mode.
3. Long press **ON** key and **WIFI** key to enter the lock setting, press **Q** key to switch Setting item, press **WIFI** and **WIFI** key to adjust the value of each parameter; the time of WIFI model will be automatically gets Internet time.
4. Press **WIFI** and **WIFI** for 5 seconds to add or cancel the child lock.
5. **WIFI Link:** When the thermostat is on, long press **WIFI** button for 5 seconds and the thermostat display will come out how the WIFI icon flashes, at this time the thermostat into the state of code.

⑫

THERMOSTAT USER GUIDE

Advanced options

When POWER OFF, press the **ON** key and the **WIFI** key for 5 seconds to enter the advanced option setting.

Press **Q** to enter the next option, press **WIFI** and **WIFI** to adjust, and Long press **Q** to set the default option.

1. Temperature sensor	NTC
2. Temperature accuracy	$\pm 1^{\circ}\text{C}$
3. Power consumption	$< 1\text{W}$
4. Voltage	AC100-240V 50Hz
5. Load current	3A/16A
6. Temperature setting	-5°C ~ 60°C
7. Child lock	On/Off
8. Lock setting	On/Off
9. Time	12/24
10. Time zone	UTC+8
11. Time zone	UTC+8
12. Time zone	UTC+8
13. Time zone	UTC+8
14. Time zone	UTC+8
15. Time zone	UTC+8
16. Time zone	UTC+8
17. Time zone	UTC+8
18. Time zone	UTC+8
19. Time zone	UTC+8
20. Time zone	UTC+8
21. Time zone	UTC+8
22. Time zone	UTC+8
23. Time zone	UTC+8
24. Time zone	UTC+8
25. Time zone	UTC+8
26. Time zone	UTC+8
27. Time zone	UTC+8
28. Time zone	UTC+8
29. Time zone	UTC+8
30. Time zone	UTC+8
31. Time zone	UTC+8
32. Time zone	UTC+8
33. Time zone	UTC+8
34. Time zone	UTC+8
35. Time zone	UTC+8
36. Time zone	UTC+8
37. Time zone	UTC+8
38. Time zone	UTC+8
39. Time zone	UTC+8
40. Time zone	UTC+8
41. Time zone	UTC+8
42. Time zone	UTC+8
43. Time zone	UTC+8
44. Time zone	UTC+8
45. Time zone	UTC+8
46. Time zone	UTC+8
47. Time zone	UTC+8
48. Time zone	UTC+8
49. Time zone	UTC+8
50. Time zone	UTC+8
51. Time zone	UTC+8
52. Time zone	UTC+8
53. Time zone	UTC+8
54. Time zone	UTC+8
55. Time zone	UTC+8
56. Time zone	UTC+8
57. Time zone	UTC+8
58. Time zone	UTC+8
59. Time zone	UTC+8
60. Time zone	UTC+8
61. Time zone	UTC+8
62. Time zone	UTC+8
63. Time zone	UTC+8
64. Time zone	UTC+8
65. Time zone	UTC+8
66. Time zone	UTC+8
67. Time zone	UTC+8
68. Time zone	UTC+8
69. Time zone	UTC+8
70. Time zone	UTC+8
71. Time zone	UTC+8
72. Time zone	UTC+8
73. Time zone	UTC+8
74. Time zone	UTC+8
75. Time zone	UTC+8
76. Time zone	UTC+8
77. Time zone	UTC+8
78. Time zone	UTC+8
79. Time zone	UTC+8
80. Time zone	UTC+8
81. Time zone	UTC+8
82. Time zone	UTC+8
83. Time zone	UTC+8
84. Time zone	UTC+8
85. Time zone	UTC+8
86. Time zone	UTC+8
87. Time zone	UTC+8
88. Time zone	UTC+8
89. Time zone	UTC+8
90. Time zone	UTC+8
91. Time zone	UTC+8
92. Time zone	UTC+8
93. Time zone	UTC+8
94. Time zone	UTC+8
95. Time zone	UTC+8
96. Time zone	UTC+8
97. Time zone	UTC+8
98. Time zone	UTC+8
99. Time zone	UTC+8
100. Time zone	UTC+8

⑬